

NORTHVILLE ART HOUSE

Main Gallery Floor Plan
780 sq. ft | 110 running ft.

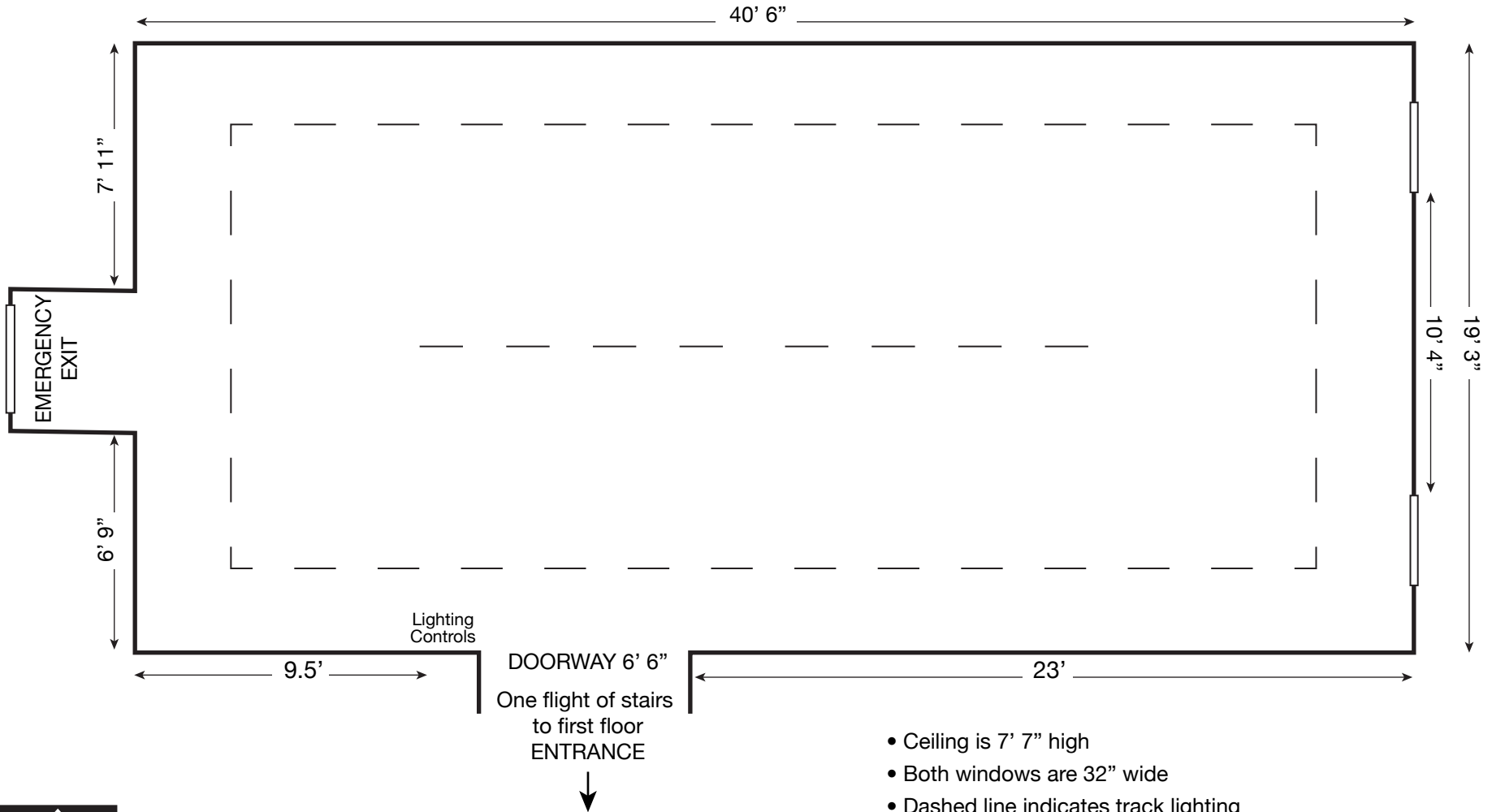

- Ceiling is 7' 7" high
- Both windows are 32" wide
- Dashed line indicates track lighting
- Moveable wall 81" x 77" x 15" available
- Varying sizes of 18 pedestals and 10 shelves
- Art House installs the exhibition and provides labels

